

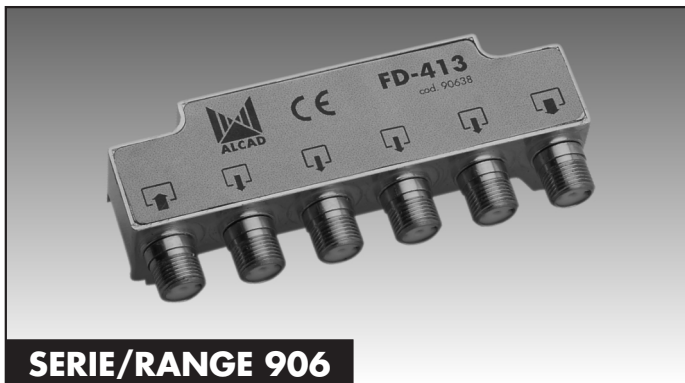

- ▶ DERIVADORES FI
- ▶ IF TAP-OFFS
- ▶ DERIVATEURS BIS
- ▶ DERIVADORES FI
- ▶ ZF ABZWEIGER



SERIE/RANGE 906

CARACTERISTICAS PRINCIPALES

MAIN FEATURES

PRINCIPALES CARACTERISTIQUES

CARACTERISTICAS PRINCIPALES

WESENTLICHE KENNZEICHEN

CODIGO-CODE-CODE-CODIGO-CODE		90653	90633	90634	90635		
TIPO-TYPE-TYPE-TIPO-TYP		FD-210	FD-213	FD-219	FD-225		
CONECTOR CONNECTOR CONNECTEUR CONECTOR STECKER		F					
SALIDAS OUTPUTS SORTIES SAIDAS AUSGANGE		2					
RANGO DE FRECUENCIAS FREQUENCY RANGE GAMME DE FREQUENCE RANGO DE FRECUENCIAS FREQUENZBEREICH		MHz 5 - 2400					
ATENUACION DE DERIVACION TAP LOSS ATTENUATION DE DERIVACION ATENUAÇÃO DE DERIVAÇÃO ABZWEIGDÄMPFUNG		5-47 MHz 47-230 MHz 470-862 MHz 950-2150 MHz 2150-2400 MHz	dB ±1,0	26,0 - 24,5 24,5 - 21,5 17,0 - 13,0 12,5 - 8,5 8,5 - 8,0	28,0 28,0 - 25,0 21,5 - 17,5 17,0 - 12,0 12,0 - 11,5	32,0 32,0 - 30,5 27,5 - 24,0 23,0 - 17,5 17,5 - 17,0	36,0 36,0 - 34,5 33,0 - 30,0 30,0 - 26,0 26,0 - 25,5
ATENUACION DE PASO THROUGH LOSS ATTENUATION DE PASSAGE ATENUAÇÃO DE PASSAGEM DURCHGANGSDÄMPFUNG		5-47 MHz 47-230 MHz 470-862 MHz 950-2150 MHz 2150-2400 MHz	dB ±0,5	0,8 0,8 - 1,0 1,2 - 1,7 1,8 - 3,0 3,0 - 3,5	0,6 0,6 - 0,7 0,9 - 1,2 1,2 - 2,0 2,0 - 2,3	0,5 0,5 0,5 - 0,8 0,8 - 1,4 1,4 - 1,6	0,5 0,5 0,5 - 0,6 0,6 - 1,0 1,2
DIRECTIVIDAD DIRECTIVITY DIRECTIVITE DIRECTIVIDAD DIRECTIVIDADE		5-47 MHz 47-862 MHz 950-2150 MHz 2150-2400 MHz	dB	> 0 > 0 - 6 > 7 > 8	> 0 > 0 - 5 > 5 - 8 > 8	> 0 > 0 - 5 > 5 - 7 > 7	> 0 > 0 - 4 > 4 - 7 > 8
DESACOPLO ISOLATION DECOUPLAGE ISOLAMENTO ENTKOPPLUNG		5-47 MHz 47-862 MHz 950-2150 MHz 2150-2400 MHz	dB	> 45 > 32 > 28 > 26	> 50 > 40 > 30 > 28	> 60 > 55 > 45 > 38	> 60 > 60 > 45 > 40
PERDIDAS DE RETORNO RETURN LOSS PERTES DE RETOUR PERDAS DE RETORNO RÜCKFLUßDÄMPFUNG		5-47 MHz 47-862 MHz 950-2150 MHz 2150-2400 MHz	dB	> 18 > 18 > 13 > 13	> 17 > 15 > 15 > 13	> 18 > 18 > 15 > 13	> 18 > 18 > 15 > 13

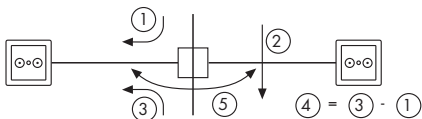

CARACTERISTICAS PRINCIPALES

MAIN FEATURES

PRINCIPALES CARACTERISTICAS

CARACTERISTICAS PRINCIPALI

WESENTLICHE KENNZEICHEN

CODIGO-CODE-CODE-CODIGO-CODE		90654	90638	90639	90640	
TIPO-TYPE-TYPE-TIPO-TYP		FD-410	FD-413	FD-419	FD-425	
CONECTOR CONNECTOR CONNECTEUR CONECTOR STECKER		F				
SALIDAS OUTPUTS SORTIES SAIDAS AUSGÄNGE		4				
RANGO DE FRECUENCIAS FREQUENCY RANGE GAMME DE FREQUENCE RANGO DE FRECUENCIAS FREQUENZBEREICH		MHz 5 - 2400				
ATENUACION DE DERIVACION TAP LOSS		5-47 MHz	27,0 - 25,5	28,0	33,0	36,0
		47-230 MHz	25,5 - 22,5	28,0 - 26,0	33,0 - 31,0	36,0 - 34,5
①	ATTENUATION DE DERIVACION ATENUAÇÃO DE DERIVAÇÃO	470-862 MHz	18,8 - 15,0	22,5 - 18,5	28,0 - 24,0	32,5 - 30,0
		950-2150 MHz	14,5 - 10,2	18,0 - 13,5	23,5 - 18,5	30,0 - 25,5
		2150-2400 MHz	10,2 - 9,7	13,5	18,5 - 17,5	25,5 - 25,0
ATENUACION DE PASO THROUGH LOSS		5-47 MHz	1,5 - 1,7	1,0	0,5	0,5
		47-230 MHz	1,7 - 1,8	1,0 - 1,3	0,5 - 0,8	0,5 - 0,6
②	ATTENUATION DE PASSAGE ATENUAÇÃO DE PASSAGEM	470-862 MHz	2,1 - 2,7	1,5 - 2,0	0,9 - 1,0	0,7 - 0,9
		950-2150 MHz	2,9 - 4,7	2,0 - 3,0	1,2 - 1,8	0,9 - 1,3
		2150-2400 MHz	4,7 - 5,0	3,0 - 3,5	1,8 - 2,0	1,3 - 1,5
DIRECTIVIDAD DIRECTIVITY		5-47 MHz	> 0	> 0	> 0	> 0
		47-862 MHz	> 0 - 6	> 0 - 6	> 0 - 6	> 0 - 5
④	DIRECTIVITE DIRECTIVIDAD	950-2150 MHz	> 6	> 6	> 6	> 5 - 7
		2150-2400 MHz	> 7	> 6	> 6	> 7
DESACOPLO ISOLATION		5-47 MHz	> 45	> 50	> 60	> 60
		47-862 MHz	> 35	> 40	> 55	> 60
⑤	DECOUPLAGE ISOLAMENTO	950-2150 MHz	> 30	> 32	> 45	> 45
		2150-2400 MHz	> 30	> 32	> 40	> 40
PERDIDAS DE RETORNO RETURN LOSS		5-47 MHz	> 15	> 15	> 17	> 18
		47-862 MHz	> 15	> 16	> 18	> 18
PERTES DE RETOUR PERDAS DE RETORNO		950-2150 MHz	> 13	> 16	> 17	> 17
		2150-2400 MHz	> 13	> 16	> 15	> 16

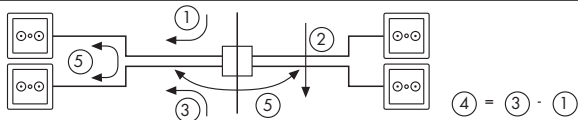

- ▶ COMO PREPARAR LOS CONECTORES F
- ▶ HOW TO PREPARE THE F CONNECTORS
- ▶ COMMENT PREPARER LES CONNECTEURS F
- ▶ COMO PREPARAR OS CONECTORES F
- ▶ KABEL VORBEREITUNG FÜR F-STECKER

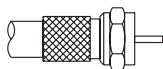
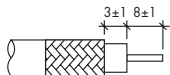
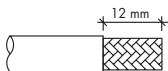

- ▶ INSTALACION
- ▶ INSTALLATION
- ▶ INSTALLATION
- ▶ INSTALAÇÃO
- ▶ ANLAGE

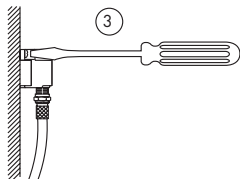
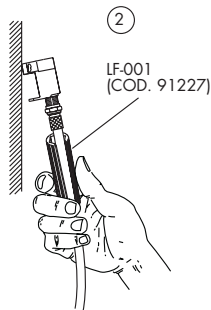
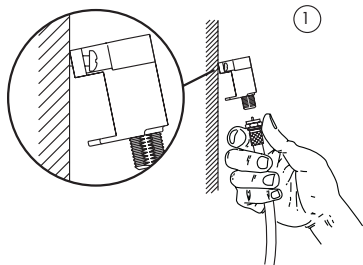

- ▶ CONEXION A TIERRA
- ▶ DOWN TO EARTH CONNECTION
- ▶ MISE A LA TERRE
- ▶ CONEXÃO A TOMADA DE TERRA
- ▶ ANSCHLUß FÜR ERDUNGSKABEL

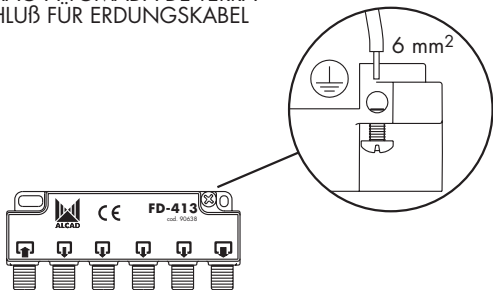

- ▶ MONTAJE EN INTEMPERIE
- ▶ OUTDOORS MOUNTING
- ▶ MONTAGE EXTERNE
- ▶ MONTAGEM EM INTEMPERIE
- ▶ AUßENMONTAGE

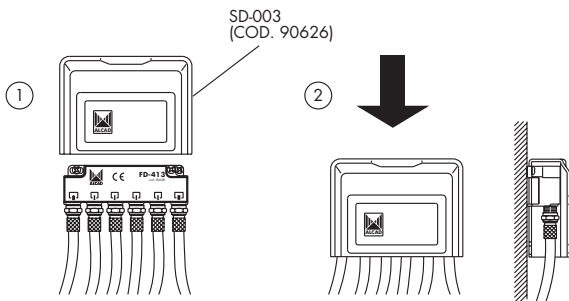

- ▶ ESQUEMA CON 2 VIVIENDAS POR PLANTA
- ▶ SCHEMA FOR 2 FLATS PER FLOOR
- ▶ ESQUEMA POUR 2 LOGEMENTS PAR ETAGE
- ▶ ESQUEMA CON 2 VIVIENDAS POR PLANTA
- ▶ SCHEMA FÜR INSTALLATION MIT 2 ANSCHÜSSEN PRO ETAGE

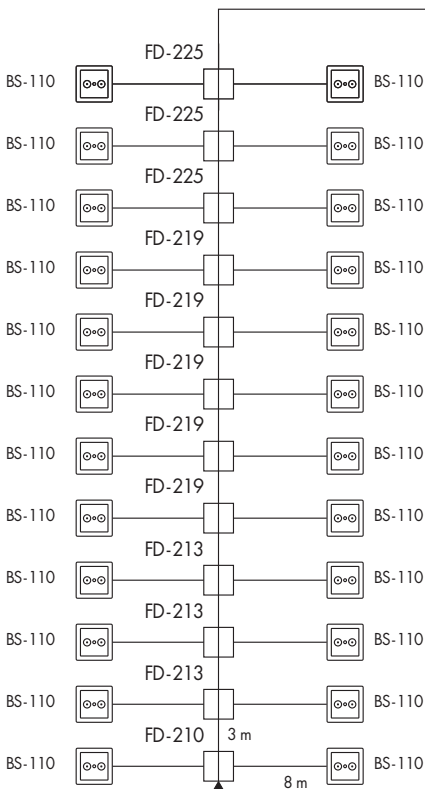
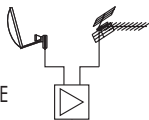

- ▶ ESQUEMA CON 4 VIVIENDAS POR PLANTA
- ▶ SCHEMA FOR 4 FLATS PER FLOOR
- ▶ ESQUEMA POUR 4 LOGEMENTS PAR ETAGE
- ▶ ESQUEMA CON 4 VIVIENDAS POR PLANTA
- ▶ SCHEMA FÜR INSTALLATION MIT 4 ANSCHÜSSEN PRO ETAGE

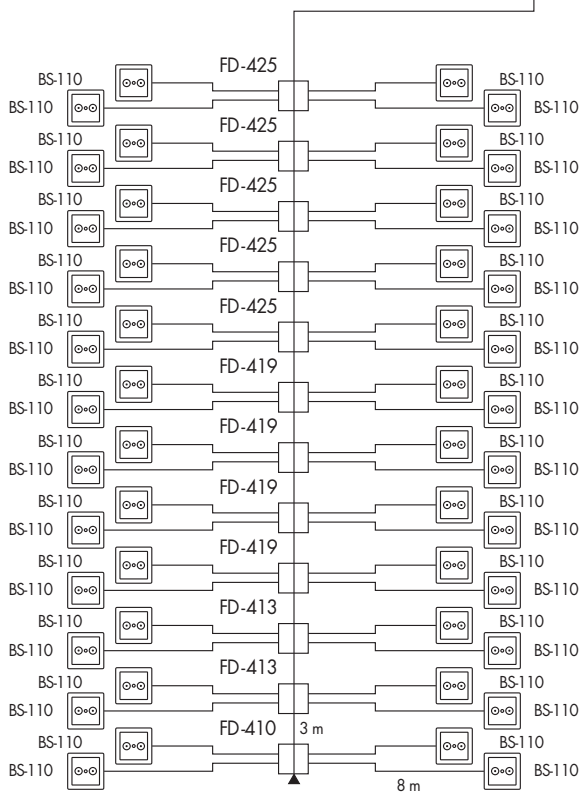
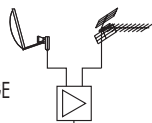



DECLARATION OF CONFORMITY

according to EN 45014

Manufacturer's Name: ALCAD, S.A.

Manufacturer's Address: Polígono Industrial de Ventas
C/Gabiria, 15 - Apdo. 455
20305 IRUN (Guipúzcoa)
SPAIN

declares that the product

Product Name: 906 Series: TAP-OFFS

Model Number(s): FD-210, FD-213, FD-219, FD-225, FD-410, FD-413,
FD-419, FD-425

Product Option(s): INCLUDING ALL OPTIONS

is in conformity with:

Safety: EN50083-1

EMC: EN 50083-2, EN 50081-1 Electromagnetic Compatibility for Equipment
IEC 61000-4-2:1995 / EN 50082-1:1997 ESD 8KV AD, 4KV CD.
IEC 61000-4-4:1995 / EN 50082-1:1997 EFT 0,5KV-5KHz Sig. Lines, 1KV-5KHz Power Lines.
IEC 61000-4-5:1995 / EN 50082-1:1997 CWG 1KV Power Lines.
IEC 61000-4-11:1994 / EN 50082-1:1997 Dips and Variation.

Technical Features : EN50083-4

Supplementary Information:

The product herewith complies with the requirements of the Low Voltage Directive 73/23/ECC, and the EMC Directive 89/336/EEC and their relevant amendments, gathered under the directives 93/68/EEC.

Note: to comply with these directives, do not use the products without covers and operate the system as specified.



Irún,

22-06-01

Date

Anton Galarza / General Manager



ALCAD, S.A.
Tel. 943 63 96 60
Fax 943 63 92 66
Int. Tel. +34 - 943 63 96 60
info@alcad.net
Apdo. 455 - C/GABIRIA, 15
20305 IRUN - Spain
Tel. 21 - 716 10 36
Fax 21 - 716 41 09
R. Dr. JOAQUIM MANSO, 12A
1500 LISBOA - Portugal

Tel. 00 34 - 943 63 96 60
Fax 00 34 - 943 63 92 66
B.P. 284
64702 HENDAYE - France

Tel. 080 38 - 91 73
Fax 080 38 - 91 74
HOLZHAUSEN, 11
83556 GRIESSTATT - Deutschland



ISO 9001

